

# REPLACING THE 0714®/0714E® TUCKED IN NO WRINKLE LINER

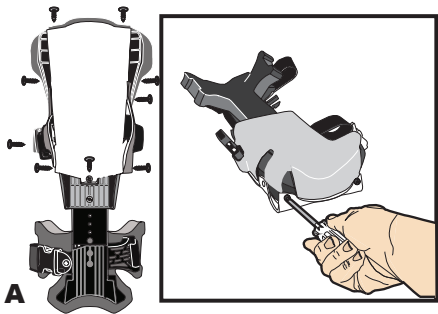
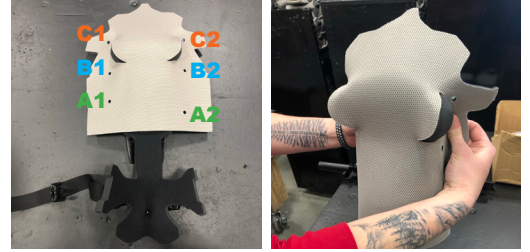

FIGURE A

**1** Remove Rubber Boot & Buckle Mount by unscrewing the 9 screws shown in Figure A. Remove old liner.

**2** Fit new liner (grey side up) over Knee Seat (Cushion Insert side up) so that ears align with slots.



**3** Attach 8½" hook strip (if needed). Wrap & loosely attach one side of liner to hook strip on front side of frame. (You will properly readjust this side in step 4e).

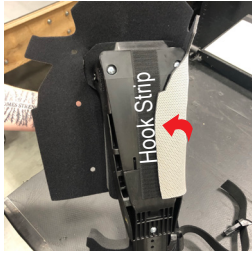

**4a** Wrap opposite side of liner to front side of frame.

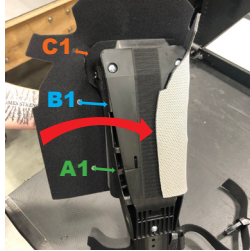

**4b** Align **A1 Liner Hole** with corresponding hole in frame.



**4c** Align **B1 Liner Hole** with corresponding hole in frame.



**4d** With **A1 & B1** holes aligned, firmly attach liner to the **Hook Strip** at the center of the frame.



**4e** Detach opposite side (from step 3) and align **A2 & B2 Liner Holes** to holes in frame before firmly attaching to **Hook Strip**.



**5** Align **C1 & C2 Liner Holes** with corresponding holes in frame, then firmly attach liner to the **Hook Strip** at the center of the frame.



**6a** Fold and tuck top wings in

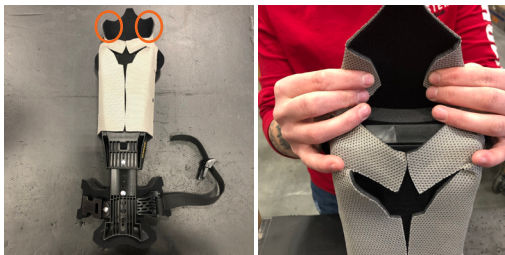

**6b** Firmly attach center peak to the **Hook Strip** at the top/center of the frame.



**7** Reattach Rubber Boot and Buckle Mount with screws.

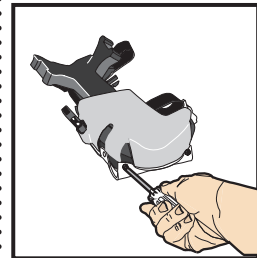

**0714®**  
**0714E®** CUSTOM MADE  
CUSTOM FIT KNEEPADS  
PATENTED WORLDWIDE

SINCE 1989  
**ProKnee®**  
MADE IN USA

PROKNEE.COM @PROKNEE @MR.PROKNEE @PROKNEE CORP

ProKnee® PRO KNEE® 0714® SMARTLOCK® are Registered Trademarks of PROKNEE® CORP. U.S. Pat.# 4772071, 4876745, 7937769, 10441007 Other Patents Pending CANADA Pat.# 2617789, 2895405 EUROPEAN Pat.# 2941136